

Schottky Diodes

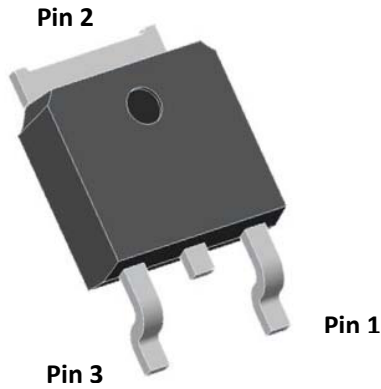

Features

- High frequency operation
- High purity, high temperature epoxy encapsulation for enhanced mechanical strength and moisture resistance
- Guard ring for enhanced ruggedness and long term reliability
- Part no. with suffix "Q" means AEC-Q101 qualified

Typical Applications

Typical applications are in switching power supplies, converters, automotive, freewheeling diodes, and reverse battery protection.

Mechanical Data

- **Package:** TO-252
Molding compound meets UL 94 V-0 flammability rating, RoHS-compliant, halogen free
- **Terminals:** Tin plated leads, solderable per J-STD-002 and JESD22-B102
- **Polarity:** As marked

■Maximum Ratings (T_a=25°C Unless otherwise specified)

PARAMETER	SYMBOL	UNIT	MBR10150CDQ
Device marking code			MBR10150CD
Repetitive peak reverse voltage	V _{RRM}	V	150
Average Rectified Output Current Per Diode (T _c =130°C) Total Device	I _{F(AV)}	A	5 10
Forward Surge Current (Non-repetitive) @60Hz Half-sine wave, 1 cycle, T _a =25°C	I _{FSM}	A	150
Current Squared Time @1ms≤t≤8.3ms T _J =25°C	I ² t	A ² s	93
Storage Temperature	T _{stg}	°C	-55 ~ +175
Junction Temperature	T _J	°C	-55 ~ +175

■Electrical Characteristics (T_a=25°C Unless otherwise specified)

PARAMETER	SYMBOL	UNIT	TEST CONDITIONS	Typ	Max	
Instantaneous forward voltage per diode	V _F	V	I _F =5A T _J =25°C	0.80	0.85	
			I _F =5A T _J =125°C	0.67	0.75	
Typical junction capacitance per diode	C _J	pF	V _R =4V, f=1 MHz	125	-	
Instantaneous reverse current per diode	I _R	mA	V _R =150V	T _J =25°C	-	0.05
				T _J =125°C	-	1

■Thermal Characteristics (T_a=25°C Unless otherwise specified)

PARAMETER	SYMBOL	UNIT	MBR10150CDQ	
Typical thermal resistance per diode	Between junction and case	R _{θJ-C}	°C/W	5



MBR10150CDQ

■ Characteristics (Typical)

Fig.1: Forward Current Derating Curve

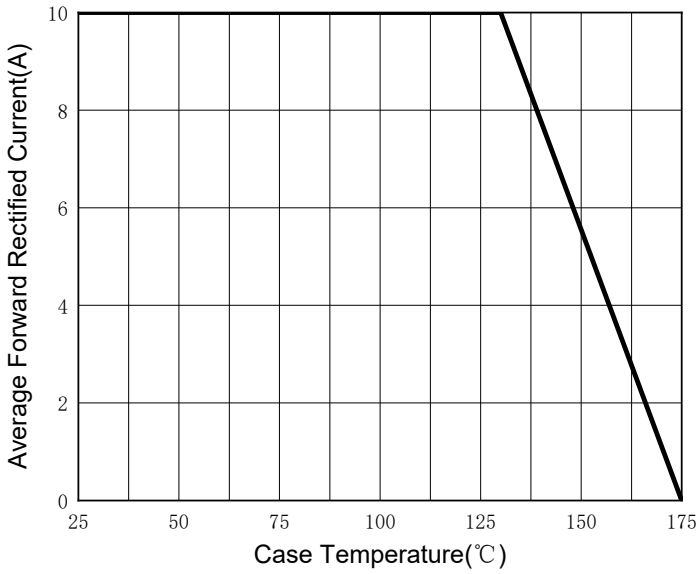

Fig.2: Forward Surge Current Capability(Per Diode)

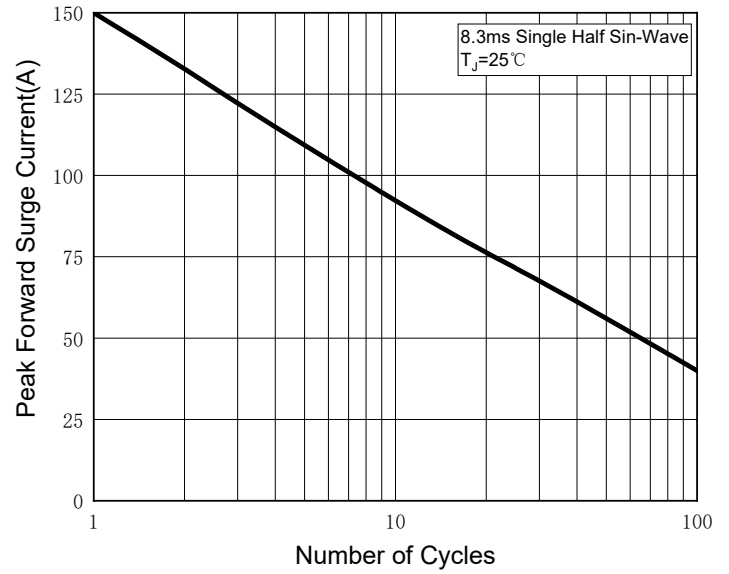

Fig.3: Typical Instantaneous Forward Characteristics(Per Diode)

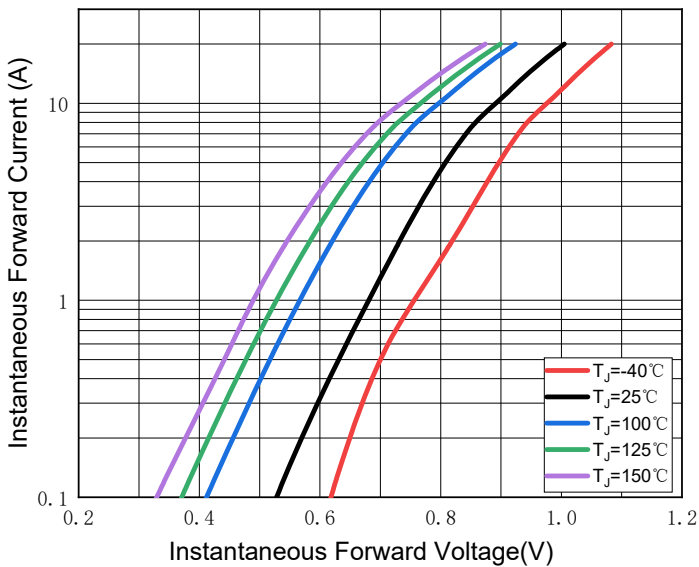

Fig.4: Typical Reverse Leakage Characteristics(Per Diode)

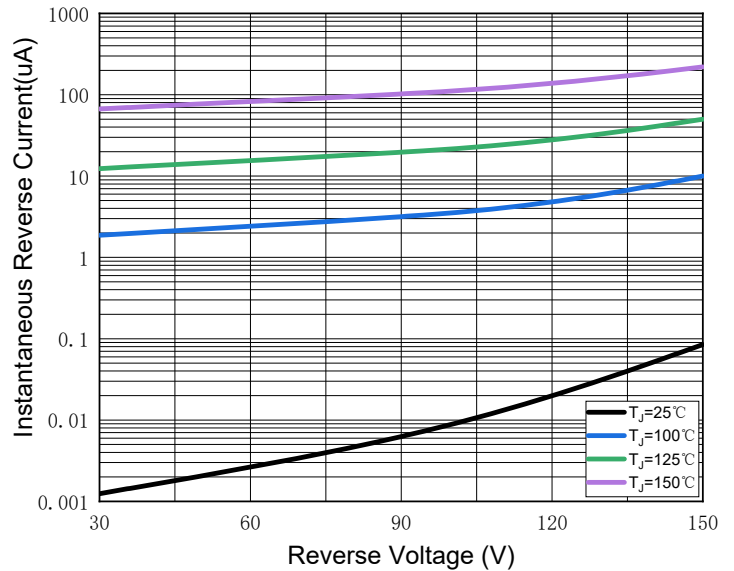
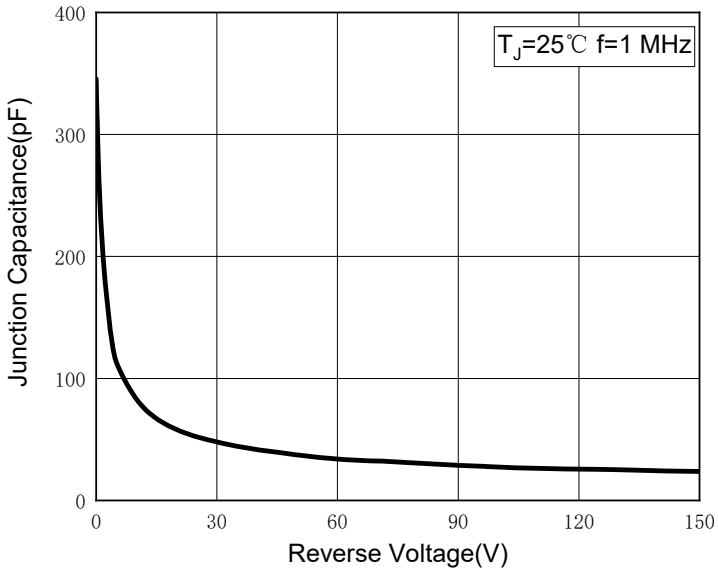

Fig.5: Typical Junction Capacitance(Per Diode)





MBR10150CDQ

Ordering Information (Example)

PREFERRED P/N	UNIT WEIGHT(g)	MINIIMUM PACKAGE(pcs)	INNER BOX QUANTITY(pcs)	OUTER CARTON QUANTITY(pcs)	DELIVERY MODE
MBR10150CDQ	Approximate 0.32	2500	2500	25000	Reel

Outline Dimensions

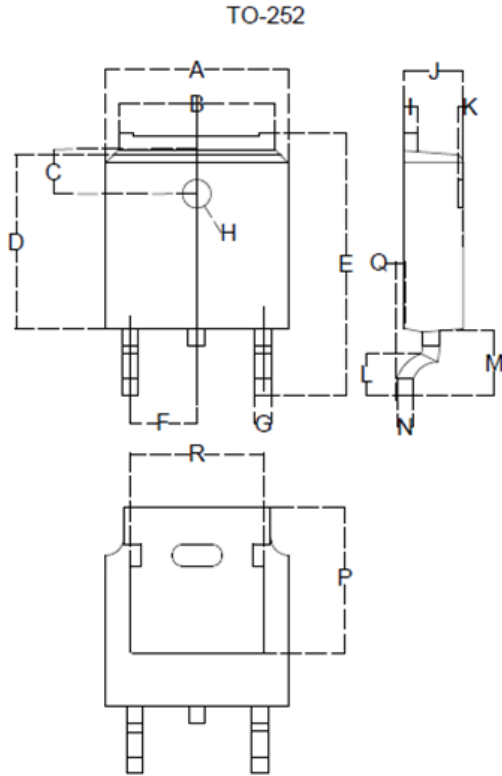

Dimensions in millimeters

TO-252		
Dim	Min	Max
A	6.500	6.700
B	5.100	5.460
C	1.400	1.800
D	6.000	6.200
E	10.000	10.400
F	2.166	2.366
G	0.660	0.860
H	Φ 1.050	Φ 1.350
I	0.460	0.580
J	2.200	2.400
K	0	0.300
L	0.890	2.290
M	2.730	3.080
N	0.430	0.580
P	5.15	5.45
Q	0	0.2
R	4.500	5.100

Suggested Pad Layout

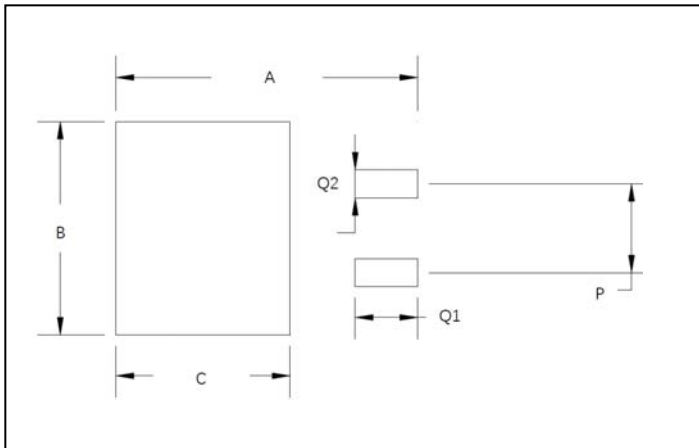

Dim	Millimeters
A	10.70
B	5.70
C	6.23
P	4.532
Q1	2.25
Q2	1.21



MBR10150CDQ

Disclaimer

The information presented in this document is for reference only. Yangzhou Yangjie Electronic Technology Co., Ltd. reserves the right to make changes without notice for the specification of the products displayed herein to improve reliability, function or design or otherwise.

The product listed herein is designed to be used with automotive electronics, are not designed for use in medical, lifesaving, lifesustaining, or military, Yangjie or anyone on its behalf, assumes no responsibility or liability for any damages resulting from such improper use of sale.

This publication supersedes & replaces all information previously supplied. For additional information, please visit our website [http:// www.21yangjie.com](http://www.21yangjie.com) , or consult your nearest Yangjie's sales office for further assistance.